



***RAD TORQUE SYSTEMS - THERE IS A BETTER WAY***



***LEADING MANUFACTURER OF ADVANCED TORQUE SYSTEMS***



***PNEUMATIC***



***BATTERY***



***ELECTRONIC***



***ELECTRIC***



## **TABLE OF CONTENTS**

### ***PNEUMATIC***

Gen-X Series .....	1
High Speed Series .....	2
OTR Mining Series .....	3
Wheel Nut Bolting Series .....	3
Classic Series .....	3

### ***ELECTRONIC***

E-RAD Series .....	4
E-RAD Controllers & Options .....	5

### ***DIGITAL***

Digital Battery Series .....	6
Digital V-RAD Series .....	7

### ***BATTERY***

B-RAD Series .....	8
--------------------	---

### ***ELECTRIC***

V-RAD Series .....	8
--------------------	---

### ***SMART SOCKET***

Smart Socket Series .....	9
---------------------------	---

### ***ACCESSORIES***

Reaction Arms .....	10
Nose Extensions .....	11
RAD Calibration .....	11

### ***REFERENCE***

Company Profile .....	12
Product Reference Chart .....	13



## PNEUMATIC SERIES

### GEN-X SERIES

Precision design and engineering has brought about the next generation in torque wrenches – the **RAD® GEN-X SERIES**.

Designed for extreme duty use in a variety of industries worldwide, **RAD® GEN-X SERIES** torque wrenches offer:

- ✓ The ultimate in power-to-weight ratio
- ✓ Wide torque range to suit multiple applications
- ✓ Unmatched reliability delivered by one of the most advanced engineered gear boxes on the market
- ✓ Controlled torque - accuracy of  $\pm 5\%$ , and repeatability of  $\pm 2\%$

## Extreme Duty Torque Wrenches for Heavy Duty Applications



**RAD® 10GX**



**RAD® 25GX**



**RAD® 34GX**



### GEN-X SERIES DIMENSIONS

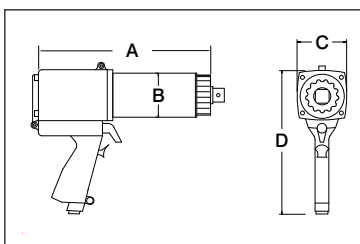

**All RAD® Pneumatic Series tools include reaction arm, 12' hose & fittings and all new ergonomic regulator cage**

PART NUMBER	TOOL MODEL	DRIVE SIZE	TORQUE (ft. lbs.)		RPM	WEIGHT (lbs.)	NOISE LEVEL	DIMENSION A	DIMENSION B	DIMENSION C	DIMENSION D
12814	7GX	0.75"	100	700	30	8.0	80 db	9.0"	2.5"	2.75"	9.0"
12818	10GX	0.75"	200	1000	20	8.0	80 db	8.15"	2.5"	2.75"	8.07"
17328	15DX	1.0"	300	1500	10	8.6	80 db	8.0"	2.7"	2.75"	8.1"
12377	25GX	1.0"	500	2500	9	13.5	85 db	9.7"	3.1"	3.3"	9.5"
12356	*34GX	1.0"	1000	3400	12	20.0	85 db	12.5"	3.4"	3.7"	10.8"
15328	60DX	1.5"	2000	6000	6.6	27.6	85 db	13.7"	4.0"	4.0"	10.9"
12383	85GX	1.5"	3000	8500	4.5	38.5	85 db	17.0"	4.5"	4.5"	11.0"

\* Also available in 1.5" Square Drive for Heavy Duty Applications.

Accuracy of  $\pm 5\%$ , Repeatability of  $\pm 2\%$



## HIGH SPEED SERIES

The **RAD® HIGH SPEED SERIES** torque wrenches incorporate a precision engineered high speed gear box designed for faster run down on time sensitive bolting applications.



Introduced to compliment the RAD GX series torque wrenches, the high speed series offer the same reliable and dependable solution for the installation and removable of heavy-duty fasteners.



**All RAD® Pneumatic Series tools include reaction arm, 12' hose & fittings and all new ergonomic regulator cage**

- ✓ **The Ultimate in Power-to-Weight Ratio**
- ✓ **Versatile Torque Ranges: 300 - 2,500 ft.lbs**
- ✓ **Extreme Torque with High RPM Productivity**

### HIGH SPEED SERIES DIMENSIONS

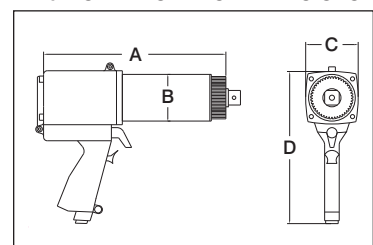

PART NUMBER	TOOL MODEL	DRIVE SIZE	TORQUE (ft. lbs.)		RPM	WEIGHT (lbs.)	NOISE LEVEL	DIMENSION A	DIMENSION B	DIMENSION C	DIMENSION D
			LOW	HIGH							
10644	10GX-2	0.75"	350	1000	85	9.9	80 db	10.3"	2.5"	2.75"	8.1"
17068	15DX-2	1.0"	500	1500	50	10.5	80 db	9.9"	2.7"	2.75"	8.1"
19773	25GX-2	1.0"	700	2500	44	16.6	80 db	12.0"	3.1"	3.3"	10.0"



## RAD® OTR MINING SERIES

## WHEEL NUT BOLTING SERIES

The **RAD® WHEEL NUT BOLTING SERIES** and the **RAD® OTR MINING SERIES** were designed with one job in mind - **wheel nut bolting** for light and heavy duty applications where torque control is a must.

- ✓ Removable custom reaction arms designed to fit virtually any wheel configuration

### GX-R SERIES DIMENSIONS

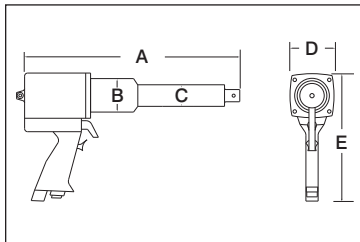

RAD® 7GX-R



PART NUMBER	TOOL MODEL	DRIVE SIZE	TORQUE (ft. lbs.)		RPM	WEIGHT (lbs.)	NOISE LEVEL	DIMENSION A	DIMENSION B	DIMENSION C	DIMENSION D	DIMENSION E
			LOW	HIGH								
13495	7GX-R	0.75"	300	700	115	12.0	80 db	14.5"	2.5"	2.0"	2.75"	9.0"
13477	1800NGX-R	1.0"	500	1800	10	27.5	85 db	21.5"	3.0"	2.0"	3.3"	9.5"

## CLASSIC SERIES

**RAD® CLASSIC SERIES** torque wrenches offer a reliable and dependable solution for the installation and removal of heavy-duty fasteners in a variety of industries that require accuracy, power, and safety.

- ✓ **PATENTED** Planetary gear reduction drive system
- ✓ Smooth continuous flow of controlled torque eliminating destructive hammering
- ✓ Lightweight ergonomic pistol grip design reducing operator strain and injury; resulting in increased productivity

### CLASSIC SERIES DIMENSIONS

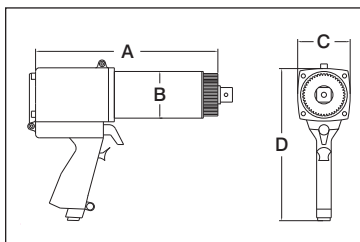

Custom Reaction Arms Available



**All RAD® Pneumatic Series tools include reaction arm, 12' hose & fittings and all new ergonomic regulator cage**

PART NUMBER	TOOL MODEL	DRIVE SIZE	TORQUE (ft. lbs.)		RPM	WEIGHT (lbs.)	NOISE LEVEL	DIMENSION A	DIMENSION B	DIMENSION C	DIMENSION D
			LOW	HIGH							
12316	350SL	0.75"	50	350	65	6.0	80 db	6.6"	2.4"	2.75"	8.75"
12342	1800NG	1.0"	500	1800	13	12.5	85 db	9.0"	3.0"	3.3"	9.5"
12357	50	1.5"	1500	5000	8	28.0	85 db	13.9"	4.0"	3.7"	10.4"

Accuracy of +/-5%, Repeatability of +/-2%



## E-RAD® SERIES

**E-RAD® SERIES** pistol grip electronic torque wrenches are lighter, faster, stronger, and more reliable than other conventional means of bolting. Accurate to  $\pm 3\%$ , this patented tool ensures that each bolt will be tightened to exacting standards.



LED lights located on both sides



Forward/Reverse Switch



Integrated Fan Kit

## PRECISION BOLTING DRIVEN BY TECHNOLOGY AND DESIGN

### LIGHTER

Combining the latest advancements in ergonomic design along with an ultra-durable portable carrying case, the E-RAD Series torque system is a lightweight alternative to other bolting systems.

### FASTER

Compared to hydraulic wrenches, the E-RAD decreased tightening times by up to 300% through the delivery of smooth and continuous torque.

### STRONGER

With unsurpassed power-to-weight ratio and our legendary patented gearbox design, E-RAD Series tools offer the highest dependability and reliability in the industry.



## ELECTRIC SERIES DIMENSIONS

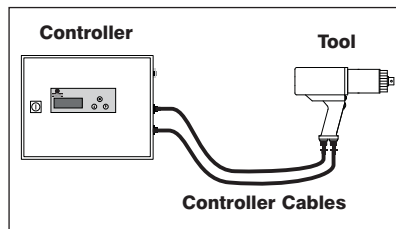
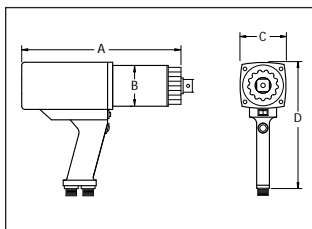

All E-RAD Series tools come fully calibrated complete with:

- E-RAD Tool
- Controller Cables
- Operators Manual
- Reaction Arm and Retention Ring
- E-RAD Touch Controller

PART NUMBER	TOOL MODEL	DRIVE SIZE	TORQUE (ft. lbs.)		WEIGHT (lbs.)	DIMENSION A	DIMENSION B	DIMENSION C	DIMENSION D
			LOW	HIGH					
14991	E-RAD 700	0.75	100	700	12	13.25"	2.5"	3.0"	8.25"
12313	E-RAD 1200	1.0"	200	1200	15	13.9"	3.0"	3.0"	8.25"
12314	E-RAD 2000	1.0"	250	2000	18	14.33"	3.0"	3.5"	8.75"
15710	E-RAD 2500 COMP	1.0"	250	2500	18	14.8"	3.0"	3.0"	8.25"
12703	E-RAD 3000	1.0"	500	3000	23.5	16.75"	3.4"	3.5"	8.75"
13992	E-RAD 4000	1.5"	800	4000	31	17.75"	4.0"	3.5"	8.75"
15952	E-RAD 6000	1.5"	1500	6000	29	16.5"	4.0"	3.5"	8.75"

Accuracy of  $\pm 3\%$



## E-RAD® SERIES CONTROLLERS AND OPTIONS

### E-RAD® FEATURES

- ✓ **Push-button select torque**  
Fast and convenient error-free digital single increment torque settings
- ✓ **Lightweight and Ergonomic grip design**  
Advanced low-profile handle to reduce operator fatigue and increase productivity
- ✓ **Extremely low noise level only 75db**  
World's quietest extreme torque gun, ideal for sensitive environments
- ✓ **LED Green (Pass) or Red (Fail) indicator lights**  
Unmistakable visual signal indicates status of torque procedure for maximum accuracy and speed



Also available in steel configuration



### E-RAD TOUCH

#### Controller Case

The E RAD touch control case provides the interface for all E RAD Tools. The touch screen allows for quick adjustments and easily selectable pre-sets.

- ✓ **Touch screen - 2" x 3"**
- ✓ **Standard with torque and angle**
- ✓ **Field calibration, password protected**
- ✓ **Life cycle and maintenance counters**
- ✓ **Advanced data collection**



#### SELECT ONE OF THE FOLLOWING CONTROLLERS

PART NUMBER	DESCRIPTION	CASE TYPE	VOLTAGE	LENGTH DIMENSION	HEIGHT DIMENSION	WIDTH DIMENSION
17026	CONTROLLER	STEEL ASSEMBLY	120	14.9"	11.8"	8.0"
16499	CONTROLLER	WEATHERPROOF ASSEMBLY	120	13.3"	6.0"	11.6"
17027	CONTROLLER	STEEL ASSEMBLY	220	14.9"	11.8"	8.0"
16500	CONTROLLER	WEATHERPROOF ASSEMBLY	220	13.3"	6.0"	11.6"

#### SELECT ONE OF THE FOLLOWING CABLE LENGTHS

PART NUMBER	TOOL MODEL	CABLE LENGTH (Feet)
10984	CABLE LENGTH FROM CONTROLLER TO TOOL MODEL (standard with tool)	15
11845	CABLE LENGTH FROM CONTROLLER TO TOOL MODEL	20
11846	CABLE LENGTH FROM CONTROLLER TO TOOL MODEL	25



## DIGITAL BATTERY SERIES

# World's First Digital and Programmable Pistol Grip Torque Wrench

## DIGITAL B-RAD SERIES

battery powered torque wrenches are the world's first digital, cordless and lithium-ion battery tool on the market. With advanced technology containing digital display and single increment torque settings.

- ✓ **Battery Powered**
- ✓ **Single Increment Digital Torque Settings**
- ✓ **Portable and Accurate Bolting Solutions!**



**DB RAD® 500**



**DB RAD® 1000**



**DB RAD® 1500**

Ideal for applications where compressed air or electricity are not available. Light weight tool offering accurate torque for low bolt count applications.



Digital Display

### DIGITAL B SERIES DIMENSIONS

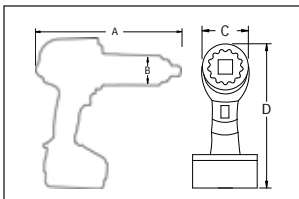

**Each Digital B-RAD Series battery wrench includes a reaction arm, two 18 volt batteries, battery charger and a weatherproof storage case.**



PART NUMBER	TOOL MODEL	DRIVE SIZE	TORQUE (ft. lbs.)		RPM	WEIGHT (lbs.)	NOISE LEVEL	DIMENSION A	DIMENSION B	DIMENSION C	DIMENSION D
16821	DB-RAD 500	0.75"	LOW	HIGH	26	11.0	80 db	12.75"	2.5"	3.0"	11.0"
16822	DB-RAD 1000	0.75"	250	1000	12	11.6	80 db	13.25"	2.5"	3.0"	11.0"
16823	DB-RAD 1500	1.0"	500	1500	8	11.8	80 db	13.75"	2.2"	3.0"	11.0"



## DIGITAL V-SERIES

### DIGITAL V-RAD SERIES

extreme design innovation with colour screen and keypad for single increment digital torque settings. Ideal for applications where compressed air is not readily available. Smooth continuous flow of controlled torque adjustable presets.



Digital Display

**Fully programmable preset torque settings**

**Torque ranges up to 2,500 ft. lbs.**

**Electric Powered**



- ✓ **Digital Display with Colour Screen**
- ✓ **Single Increment Digital Torque Settings**
- ✓ **Patented Legendary Gearbox Design**
- ✓ **Advanced durable electric motor design!**

#### DIGITAL V SERIES DIMENSIONS

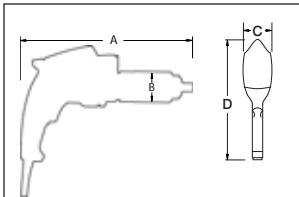

**Each Digital V-RAD Series pistol torque wrench comes fully calibrated and includes a reaction arm, retaining ring and a weatherproof storage case.**



PART NUMBER	TOOL MODEL	DRIVE SIZE	TORQUE (ft. lbs.)		RPM	WEIGHT (lbs.)	NOISE LEVEL	DIMENSION A	DIMENSION B	DIMENSION C	DIMENSION D
16120	DV-RAD 1000	0.75"	400	1000	7.7	11.4	80 db	12.66"	2.5"	2.75"	8.65"
16121	DV-RAD 1500	1.0"	600	1500	5.8	12.0	80 db	13.5"	2.7"	2.75"	8.65"
16122	DV-RAD 2500	1.0"	1000	2500	3.2	13.6	80 db	14.95"	3.1"	2.75"	8.65"



## B-RAD BATTERY SERIES

**B-RAD® BATTERY SERIES** torque wrenches offer unmatched power, versatility, and reliability. Incorporating our precision engineered gear boxes, their lightweight design makes these tools ideal for any application, especially where compressed air or electricity is not readily available.

**Just imagine the freedom....  
No Air Lines! No Power Cords! No Hassles!**



All B-RAD tools come fully calibrated complete with:

- B-RAD Tool
- Reaction Arm
- Two 18 Volt Batteries
- Battery Charger
- Calibration Chart
- Storage Case

### BATTERY SERIES DIMENSIONS

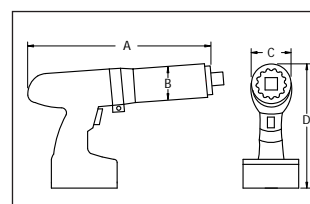

PART NUMBER	TOOL MODEL	DRIVE SIZE	TORQUE (ft. lbs.)		WEIGHT (lbs.)	DIMENSION A	DIMENSION B	DIMENSION C	DIMENSION D
			LOW	HIGH					
20086	TOOL KIT B-RAD 500	0.75"	225	475	8.4	10.07"	2.5"	2.5"	10.25"
20092	TOOL KIT B-RAD 500-2	0.75"	200	500	10.4	12.07"	2.5"	2.5"	10.25"
20087	TOOL KIT B-RAD 1000	0.75"	400	1000	8.8	10.65"	2.5"	2.5"	10.25"
20093	TOOL KIT B-RAD 1000-2	0.75"	400	1000	10.8	12.65"	2.5"	2.5"	10.25"
20088	TOOL KIT B-RAD 1500	1.0"	600	1500	9.2	10.83"	2.7"	2.7"	10.37"
20094	TOOL KIT B-RAD 1500-2	1.0"	600	1500	11.2	13.00"	2.7"	2.7"	10.37"

## V-RAD ELECTRIC SERIES

**V-RAD ELECTRIC SERIES** are a new generation of electric torque wrenches used for the installation or removal of heavy duty fasteners where accuracy, power, and safety are required.

- ✓ **Quick adjust torque settings**  
Fast and accurate "dial a torque" for maximum versatility and efficiency
- ✓ **Equal power in forward and reverse**  
Convenience and cost effective use of same tool for break away and final torque
- ✓ **Advanced ultra-durable electric motor design**  
Extreme duty design to reduce maintenance cost and increase reliability



All V-RAD tools come fully calibrated complete with:

- V-RAD Tool
- Reaction Arm
- Operators Manual
- Calibration Chart
- Storage Case

### V SERIES DIMENSIONS

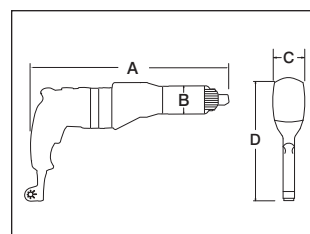

PART NUMBER	TOOL MODEL	DRIVE SIZE	TORQUE (ft. lbs.)		WEIGHT (lbs.)	DIMENSION A	DIMENSION B	DIMENSION C	DIMENSION D
			LOW	HIGH					
13497	V-RAD 4	0.75"	100	400	10.0	15.5"	2.5"	2.75"	8.0"
12899	V-RAD 10	0.75"	300	1000	11.0	17.25"	2.5"	2.75"	8.0"
12389	V-RAD 16	1.0"	500	1600	15.0	17.75"	3.0"	2.75"	8.0"
13501	V-RAD 23	1.0"	800	2300	15.0	18.0"	3.0"	2.75"	8.0"



## **SMART-SOCKET SERIES**

# **Patented Transducer Socket Torque Verification & Calibration**

## **RAD SMART-SOCKET SERIES**

uses RAD Torque's transducer technology combined with custom sockets to measure the torque applied to the socket during a torque cycle. By innovative design, the Smart Socket is no larger than a standard socket.

Compact size and innovative technology makes the Smart-Socket a perfect audit tool for inspecting bolting joints.

# **BELIEVE IT!**



- ✓ Measures and displays peak torque
- ✓ "Pass" or "Fail" indication
- ✓ Data logging - download logs onto computer
- ✓ Ideal on site calibration tool

**Current Sizes:** 60-80mm Smart-Socket  
50-60mm Smart-Socket  
46-50mm Smart-Socket



**PATENTED TECHNOLOGY**

**\*Most socket sizes available upon request**



## REACTION ARMS



	<b>STANDARD</b> (included with tool)	<b>DEEP SOCKET</b>	<b>DOUBLE ENDED ARM</b>	<b>BLANK</b>	<b>DOUBLE ENDED BLANK</b>	<b>RETAINING RING</b>
<b>PNEUMATIC</b>						
RAD 350SL	10686	10687	10688	10036	10037	10306
RAD 7GX	13366	13367	13368	13364	13365	12733
RAD 7GX-R	13512	12902	13442	13773	12903	10306
RAD 10GX	13366	13367	13368	13364	13365	12733
RAD 15DX	17375	18480	19094	17888	19093	17367
RAD 1800NG	10004	10007	10009	10005	10008	10014
RAD 1800NGX-R	13484	13515	13516	13513	13514	13476
RAD 25GX	18250	18251	10516	10513	10448	10509
RAD 34GX	11531	11534	11533	11530	11532	11350
RAD 50	10039	10401	10403	10040	10402	10032
RAD 60DX	15375	15788	15790	15373	15789	15367
RAD 85GX	12885	13508	13509	13505	13506	11930

<b>ELECTRIC</b>						
V-RAD 4	10686	10687	10688	10036	10037	10306
V-RAD 10	13366	13367	13368	13364	13365	12733
V-RAD 16	10004	10007	10009	10005	10008	10014
V-RAD 23	10514	10515	10516	10513	10448	10509

<b>BATTERY</b>						
B-RAD 500	13366	13367	13368	13364	13365	12733
B-RAD 1000	13366	13367	13368	13364	13365	12733
B-RAD 1500	17375	18480	19094	17888	19093	17367

<b>ELECTRONIC</b>						
E-RAD 700	13366	13367	13368	13364	13365	12733
E-RAD 1200	10004	10007	10009	10005	10008	10014
E-RAD 2000	10247	10395	10397	10394	10396	10038
E-RAD 2500 COMP	18250	18251	10516	10513	10448	10509
E-RAD 3000	11531	11534	11533	11530	11532	11350
E-RAD 4000	10039	10401	10403	10040	10402	10032
E-RAD 6000	16368	17643	15790	16260	15789	15367

<b>DIGITAL BATTERY</b>						
DB-RAD 500	13366	13367	13368	13364	13365	12733
DB-RAD 1000	13366	13367	13368	13364	13365	12733
DB-RAD 1500	17375	18480	19094	17888	19093	17367

<b>DIGITAL ELECTRIC</b>						
DV-RAD 1000	13366	13367	13368	13364	13365	12733
DV-RAD 1500	17375	18480	19094	17888	19093	17367
DV-RAD 2500	10514	10515	10516	10513	10448	10509

\* Please contact us if you have a specific or custom application.  
Our Engineering Department can design a reaction arm for all of your needs.  
[www.radtorque.com](http://www.radtorque.com)

Sample of Custom Reaction Arms shown below





## NOSE EXTENSION SELECTION CHART



Part Number	Description	Dimension A	Dimension B	Dimension C	Dimension D
14195	RAD 10GX NOSE EXTENSION 12"	n/a	12.75"	1.75"	n/a
14200	RAD 10GX NOSE EXTENSION 15"	n/a	15.75"	1.75"	n/a
14205	RAD 10GX NOSE EXTENSION 18"	n/a	18.75"	1.75"	n/a
18185	RAD 15DX NOSE EXTENSION 12"	n/a	13.75"	2.0"	n/a
19058	RAD 15DX NOSE EXTENSION 15"	n/a	15.75"	2.0"	n/a
19059	RAD 15DX NOSE EXTENSION 18"	n/a	18.75"	2.0"	n/a
10259	RAD 1800NG NOSE EXTENSION 12"	5.0"	12.7"	2.0"	3.5"
10257	RAD 1800NG NOSE EXTENSION 15"	5.0"	16.0"	2.0"	3.5"
10258	RAD 1800NG NOSE EXTENSION 18"	5.0"	18.0"	2.0"	3.5"
12096	RAD 25GX NOSE EXTENSION 12"	5.0"	13.0"	2.0"	3.25"
12061	RAD 25GX NOSE EXTENSION 15"	5.0"	16.0"	2.0"	3.25"
12097	RAD 25GX NOSE EXTENSION 18"	5.0"	18.5"	2.0"	3.25"
11750	RAD 34GX NOSE EXTENSION 12"	5.6"	12.5"	2.0"	3.4"
11751	RAD 34GX NOSE EXTENSION 15"	5.6"	15.5"	2.0"	3.4"
11752	RAD 34GX NOSE EXTENSION 18"	5.6"	18.5"	2.0"	3.4"

10GX and 15DX Nose Extensions require a reaction arm. Refer to 7GX-R Reaction Arms on previous charts.

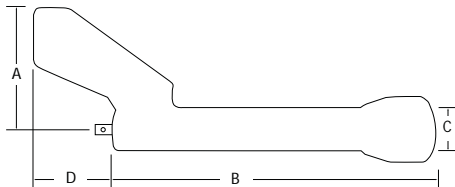

## RAD CALIBRATION SYSTEMS



**RCA-1000**  
Torque Range 100-1000ft/lb  
Accuracy +/- .25%



**RCA-3000**  
Torque Range 300-3000ft/lb  
Accuracy +/- .25%



**RCA-5000**  
Torque Range 500-5000ft/lb  
Accuracy +/- .25%



**RCA-6000**  
Torque Range 600-6000ft/lb  
Accuracy +/- .25%

## COMPANY PROFILE

# 17 YEARS INCORPORATED



New World Technologies Inc. is a leading Canadian manufacturer of pneumatic, battery powered, and electronic pistol grip torque wrenches. Our advanced products have proven to be successful all over the world in such industries as oil and gas, petrochemical, mining, aerospace, and manufacturing. We continue to invest in and employ the latest technology to achieve the highest level of innovation, quality, and performance - which has resulted in multiple patents for our products. New World Technologies Inc. has designed its operations for maximum flexibility and responsiveness ensuring our customers receive outstanding service.



- 14 CNC machining centers (Okuma and HAAS systems)
- CAD and CAM processing (Solid Works and Master Cam)
- 9 gear cutting machines (working to AGMA standards)
- 3 Professional Engineers (Mechanical and Electronics)

## MAXIMUM FLEXIBILITY AND RESPONSIVENESS, ENSURING OUR CUSTOMERS RECEIVE OUTSTANDING SERVICE



### **Highest Power-to-Weight ratio of any power tool**

All RAD® torque guns are designed to deliver the highest power-to-weight ratio of any pneumatic tool on the market today, saving you time and money in maintenance or production costs. The extremely high torque and constant rotation make our tools ideal for virtually any bolting application you will encounter. Equal power in both forward and reverse allows more diversity for tough maintenance jobs.

### **Accuracy +/-5%, repeatability 2%\***

Every RAD® air torque wrench is individually calibrated and traceable to NIST standards to help ensure joint integrity. Our tools are many times more accurate than impact wrenches and in many cases can be more precise than click type manual torque wrenches, which are often over pulled by operators.

\* With correct air supply

### **88 times less vibration than Impact wrenches...Operates at only 85 db**

RAD® torque guns are one of the safest power tools on the market today. Our exclusive low profile reaction arm takes virtually all the operational load off the operator, reducing injuries and greatly reducing operating costs. Don't wait for a time loss injury or legislation to force change in your environment, RAD® guns set the standard in bolting safety.



With continuous dedication to accuracy and precision, New World Technologies is an ISO-17025 accredited calibration laboratory.

Cert # L-2325 Calibration



## PRODUCT REFERENCE CHART

### PNEUMATIC SERIES: GEN-X

Part No.	Tool Model	Drive Size	Torque Range	RPM	Weight
12814	7GX	0.75"	100-700 ft/lbs.	30	8.0 lbs.
12818	10GX	0.75"	200-1000 ft/lbs.	20	8.0 lbs.
17328	15DX	1.0"	300-1500 ft/lbs.	10	8.6 lbs.
12377	25GX	1.0"	500-2500 ft/lbs.	9	13.5 lbs.
12356	34GX	1.0"	1000-3400 ft/lbs.	12	20.0 lbs.
15328	60DX	1.5"	2000-6000 ft/lbs.	6.6	27.6 lbs.
12383	85GX	1.5"	3000-8500 ft/lbs.	4.5	38.5 lbs.

### PNEUMATIC SERIES: CLASSIC

Part No.	Tool Model	Drive Size	Torque Range	RPM	Weight
12316	350SL	0.75"	50-350 ft/lbs.	65	6.0 lbs.
12342	1800NG	1.0"	500-1800 ft/lbs.	13	12.5 lbs.
12357	50	1.5"	1500-5000 ft/lbs.	8	28.0 lbs.

### PNEUMATIC SERIES: WHEEL NUT BOLTING SERIES

Part No.	Tool Model	Drive Size	Torque Range	RPM	Weight
13495	7GX-R	0.75"	300-700 ft/lbs.	115	12.0 lbs.
13477	1800NGX-R	1.0"	500-1800 ft/lbs.	10	27.5 lbs.
13691	10GX-NX KIT	0.75"	200-1000 ft/lbs.	20	8.0 lbs.

### ELECTRONIC SERIES: E-RAD

Part No.	Tool Model	Drive Size	Torque Range	RPM	Weight
14991	E-RAD 700	0.75"	100-700 ft/lbs.	20	12.0 lbs.
12313	E-RAD 1200	1.0"	200-1200 ft/lbs.	16	15.0 lbs.
12314	E-RAD 2000	1.0"	250-2000 ft/lbs.	7	18.0 lbs.
15710	2500 COMP	1.0"	250-2500 ft/lbs.	5.5	18.0 lbs.
12703	E-RAD 3000	1.0"	500-3000 ft/lbs.	5.5	23.5 lbs.
13992	E-RAD 4000	1.5"	800-4000 ft/lbs.	3.5	31.0 lbs.
15952	E-RAD 6000	1.5"	1500-6000 ft/lbs.	4	29.0 lbs.

### ELECTRIC SERIES: V-RAD

Part No.	Tool Model	Drive Size	Torque Range	RPM	Weight
13497	V-RAD 4	0.75"	100-400 ft/lbs.	34	10.0 lbs.
12899	V-RAD 10	0.75"	300-1000 ft/lbs.	9	11.0 lbs.
12389	V-RAD 16	1.0"	500-1600 ft/lbs.	7	15.0 lbs.
13501	V-RAD 23	1.0"	800-2300 ft/lbs.	4	15.0 lbs.

### BATTERY SERIES: B-RAD

Part No.	Tool Model	Drive Size	Torque Range	RPM	Weight
20086	B-RAD 500	0.75"	225-475 ft/lbs.	4.7	8.4 lbs.
20092	B-RAD 500-2	0.75"	200-500 ft/lbs.	28.9	10.4 lbs.
20087	B-RAD 1000	0.75"	400-1000 ft/lbs.	2.7	8.8 lbs.
20093	B-RAD 1000-2	0.75"	400-1000 ft/lbs.	11.5	10.8 lbs.
20088	B-RAD 1500	1.0"	600-1500 ft/lbs.	1.8	9.2 lbs.
20094	B-RAD 1500-2	1.0"	600-1500 ft/lbs.	9.4	11.2 lbs.

### DIGITAL V-RAD SERIES

Part No.	Tool Model	Drive Size	Torque Range	RPM	Weight
16120	DV-RAD 1000	0.75"	400-1000 ft/lbs.	7.7	11.4 lbs.
16121	DV-RAD 1500	1.0"	600-1500 ft/lbs.	5.8	12.0 lbs.
16122	DV-RAD 2500	1.0"	1000-2500 ft/lbs.	3.2	13.6 lbs.

### DIGITAL B-RAD SERIES

Part No.	Tool Model	Drive Size	Torque Range	RPM	Weight
16821	DB-RAD 500	0.75"	100-500 ft/lbs.	26	11.0 lbs.
16822	DB-RAD 1000	0.75"	250-1000 ft/lbs.	12	11.6 lbs.
16823	DB-RAD 1500	1.0"	500-1500 ft/lbs.	8	11.8 lbs.



***LIGHTER • FASTER • STRONGER***

***Believe It!***

**MINING  
OIL & GAS  
AEROSPACE  
PETROCHEMICAL  
MANUFACTURING**



[www.radtorque.com](http://www.radtorque.com)